



ITEM # 1901A

GreenGuard



1901A MOTION SENSOR

- Specifically engineered for installation in walk-in coolers and freezers.
- Uses electronic components to allow for reliable operation in extreme temperatures.
- Features a gasketed water-tight enclosure which prevents moisture and dust from entering the sensor and affecting occupancy detection.

- Operation: Passive infrared sensor detects motion and turns lights on at temperatures below freezing. Uses DIP switches to set time delay and PIR sensitivity.
- Low Bay Sensor: High density optic lens set covers a 20 ft. (7.3 m) diameter with ceiling height up to 20 ft. (6.1 m).
- High Bay Sensor: Same as the low bay sensor except with ceiling height from 20 ft. (6.1 m) to 40 ft. (12.2 m).

SPECIFICATIONS

OPERATION

Passive infrared sensor detects motion and turns lights on at temperatures below freezing. Uses DIP switches to set time delay and PIR sensitivity

COVERAGE:

LOW BAY SENSOR: High density optic lens set covers a 24 ft. (7.3m) diameter with ceiling height up to 20 ft. (6.1m).

HIGH BAY SENSOR: Same as above except with ceiling height from 20 ft. (6.1m) to 40 ft. (12.2m).

MATERIAL:
Polycarbonate

VOLTAGE:
120 /277 vac at 50/60 hz.

LOAD:
120 VAC with 0-800 W ballast;
277 VAC with 0-1200W ballast.

TIME DELAY:

Convenient DIP switch adjusts from 10 seconds to 20 minutes after walk-in is exited. Factory set to 2 min.

TEMPERATURE RATINGS:
-20° F (-28.9° C) minimum;
160° F (60° C) maximum

ELECTRICAL CONNECTION:
1/2" (12.7mm) NPT thread,
13-1/2" (342.9mm) AWG wire

MOUNTING:
Horizontal or vertical for use with all Kason light fixtures (Mounting kit included)

SAFETY STANDARDS:
IP65, UL-listed US and Canada for wet locations, and NSF

OTHER:
Suitable for wet locations. Fully gasketed and enclosed to minimize effects of temperature extremes.

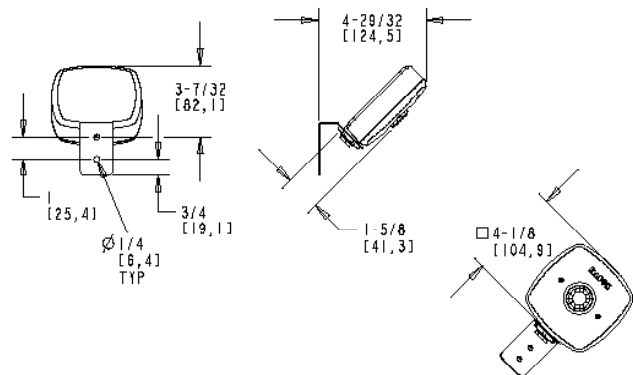

Model No.	Description
11901A00005	Low Bay Sensor with Mounting Kit
11901A00007	High Bay Sensor with Mounting Kit
Above Packaging: 10 per Carton, approx.7.5 lb. (3.4kg)	