

EDGMOUNT MECHANICAL LATCHES

- Positive latching keeps door shut tight; guards against pop-opens.
- Finger-tip touch opening
- Cylinder locking and non-locking models
- Two-way adjustment compensates for door sag and gasket wear.
- Use with all standard gaskets for economical installation.
- Compact size fits most units.

SPECIFICATIONS

MATERIAL:
High pressure die-cast zinc
body and handle, die-cast
and steel strike

FINISH:
Polished chrome

MOUNTING:
Latch is edge mounted;
strikes are surface mounted.
Drilled and countersunk for
No. 10 (5.0 mm) screws

PACKAGING:
12 per carton

WEIGHT:
Approx.
17 lb. (7.7 kg)
per carton

173 UNIVERSAL

Latch with universal strike replaces competitive latch. Strike Adjustment Range: 9/32" (7.1 mm) to 19/32" (15.1 mm)

MOUNTING:
Strike drilled for No. 10 (5.0 mm) screws

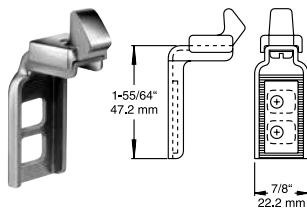

174 STANDARD

Latch body with 174 standard strike. Strike Adjustment Range: 13/32" (10.3 mm) to 23/32" (18.3 mm)

MOUNTING:
Strike drilled for No. 10 (5.0 mm) screws

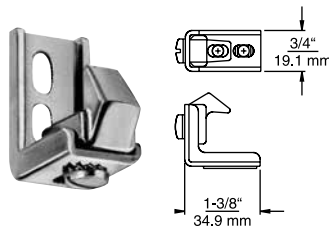

174B-14 OVEN LATCH

Oven latch with all the benefits of popular Kason No. 174 edgemount latch, plus these added features:

- Heat-resistant brass roller
- Cool-touch handle with plastic sleeve
- Complements Kason No. 1216-31 Hi-Temp brass oven hinge

STRIKE ADJUSTMENT RANGE:
13/32" to 23/32"
(10mm-18mm)

Model No.	Description
10173000004	Straight Handle, Non-Locking
10173B00004	Offset Handle, Non-Locking
10173C00004	Straight Handle, Cylinder Lock
10173BC00004	Offset Handle, Cylinder Lock
10174000004	Straight Handle, Non-Locking
10174B00004	Offset Handle, Non-Locking
10174B00014	Hi-Temp Latch Brass Roller, Offset Handle w Plastic Sleeve
10174C00004	Straight Handle, Cylinder Lock
10174B00004	Offset Handle, Cylinder Lock
90174C00012	Cylinder Kit for 173, 174, & 176

Cylinder locks may be keyed alike or differently. 5 key changes available; Please specify.
Models available with heat-resistant vinyl sleeve.

LATCH BODY



OFFSET

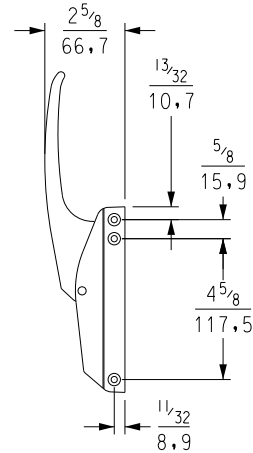

STRAIGHT

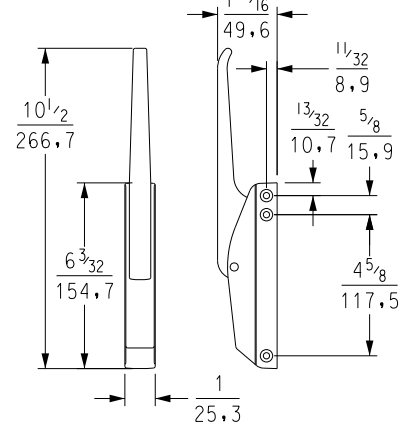

174B-14 HI-TEMP

